

FOR PRESENTATION PURPOSES ONLY

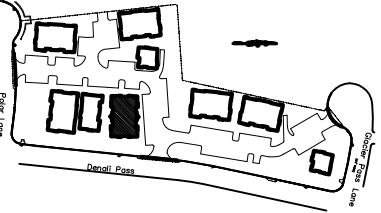

PROJECT NAME: Breakaway Park office Condos Daniel Pass Cedar Park, TX 78613 Travis County

First Floor Plan
 DATE: 22 October 2007
 SCALE: AS NOTED

SHEET NO. **A1.02**

- GENERAL NOTES**
1. ALL DIMENSIONS ARE FROM FACE OF STUD TO FACE OF STUD UNLESS NOTED OTHERWISE.
 2. DIMENSION STRINGS ARE TO THE CENTER LINE OF THE OPENING UNLESS NOTED OTHERWISE. DIMENSION STRINGS ARE 6" FROM THE INSIDE CORNER TO THE HINGE-SIDE JAMB.
 3. ALL WALL MARKS MUST BE SANDED.
 4. ALL TRIM SHALL BE CONTINUOUS WHERE POSSIBLE, OR ALIGN W/ ADJACENT WALLWORK.
 5. WALL, FLOOR & CEILING FRAMING TO BE COORDINATED WITH FIXTURE INSTALLATION. FIXTURES TO TAKE PRECEDENCE. ADJUST FLOOR/ROOF FRAMING AS NECESSARY TO ALLOW FIXTURE TO BE IN LOCATION AS SHOWN ON MEP PLANS.
 6. GENERAL CONTRACTOR TO FIELD VERIFY ALL CONDITIONS AND DIMENSIONS.
 7. ALL HAND/GUARD RAILS TO BE INSTALLED PER CODE.
 8. PROVIDE TEMPERED GLASS IN DOORS AND WINDOWS.
 9. PROVIDE THERMAL INSULATION IN ALL AREAS REQUIRED AND SPECIFIED BY CODE.
 10. ALL STAIR RISERS AND TREADS SHALL BE EQUAL UNLESS NOTED OTHERWISE.

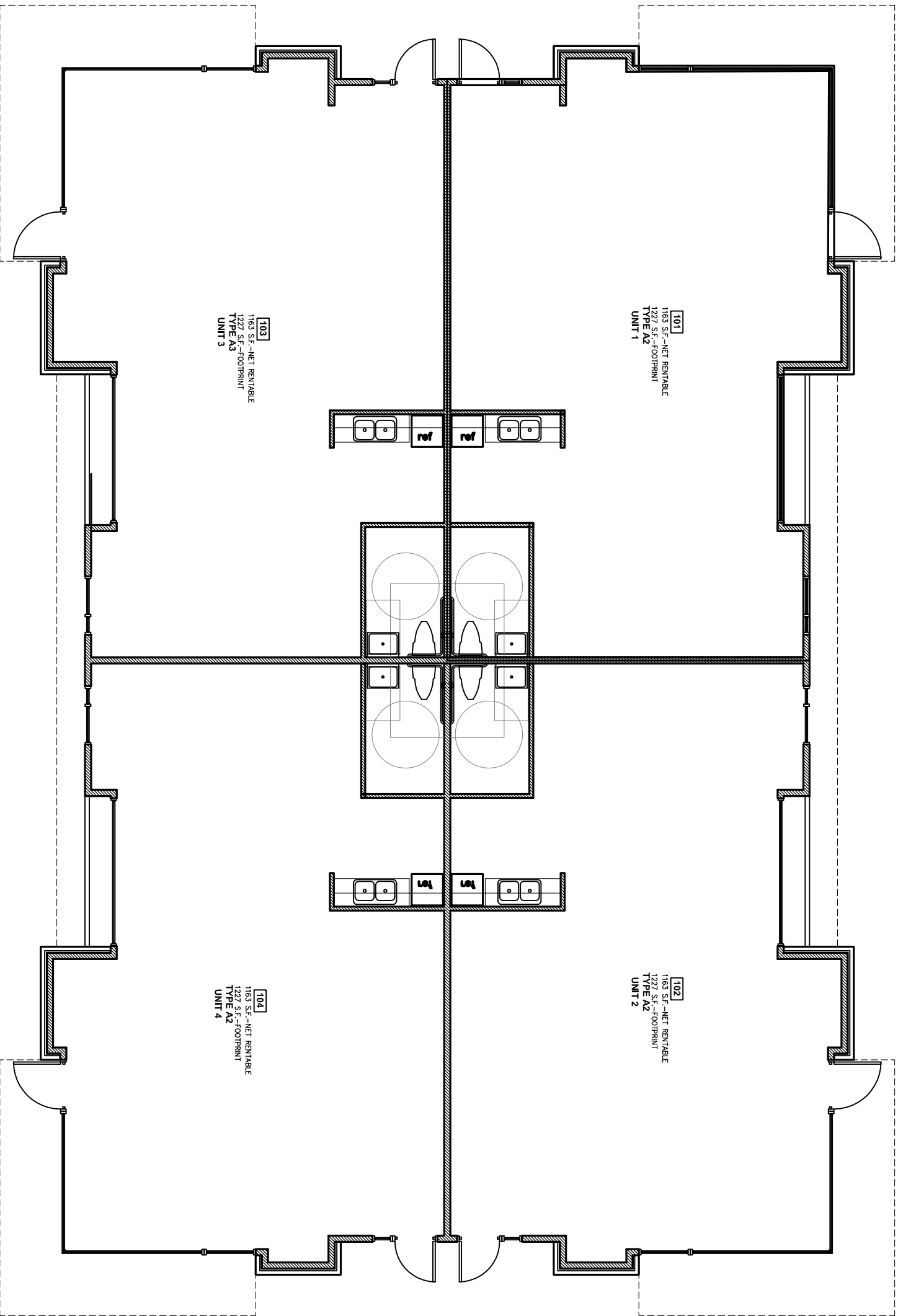

101
 1163 S.F.-NET RENTABLE
 1227 S.F.-FOOTPRINT
 TYPE A2
 UNIT 1

102
 1163 S.F.-NET RENTABLE
 1227 S.F.-FOOTPRINT
 TYPE A2
 UNIT 2

103
 1163 S.F.-NET RENTABLE
 1227 S.F.-FOOTPRINT
 TYPE A3
 UNIT 3

104
 1163 S.F.-NET RENTABLE
 1227 S.F.-FOOTPRINT
 TYPE A2
 UNIT 4



First Floor Plan Building A2
 SCALE: 1/4" = 1'-0"